

Data sheet

Support roller NATR 25 PP (crowned, with axial guidance, cage, seal)

Designation	NATR 25 PP
Type	crowned
D [mm]	52
d [mm]	25
d1 [mm max.]	42
B1 [mm]	25
B [mm]	24
r [mm]	1
Dynamic load Crw[N]	15400
Static load C0rw[N]	26500
Speed limit [min-1]	3600
Speed limit [min-1]	3600

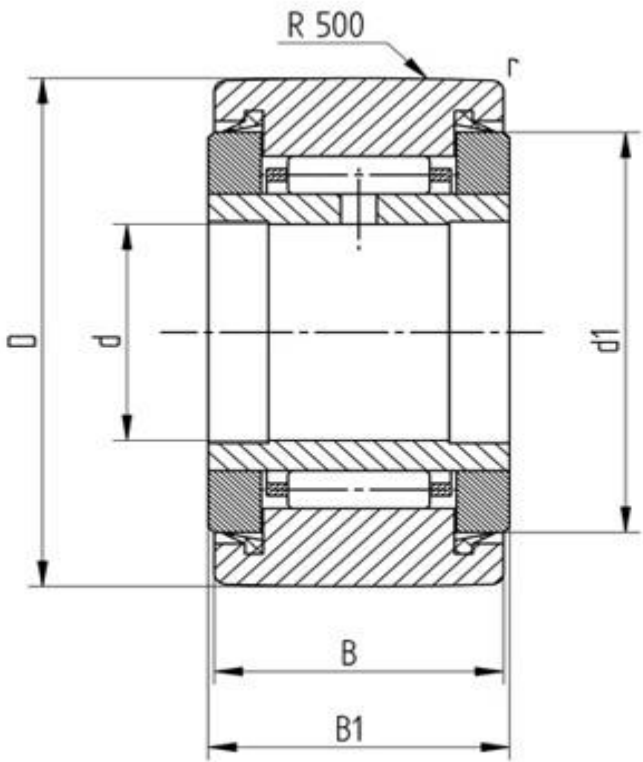

Every specification has been edited and verified carefully. STI Bearings GmbH assumes no liability for potential errors or incompleteness. Technical modifications are subject of changes.

© 2020 by STI Bearings GmbH
Reproduction, even excerpts, only with our approval.